

**- Mechanical services in sunspace**

At date of monitoring (April 2000) three of the five conservatories had wood burning stoves.

Ventilation is natural

**- Floor type**

300 mm concrete on 300mm high density polystyrene insulation

**- Monitoring**

Conservatories are used for occasional sitting, playing, plant propagation, clothes drying and sometimes for meals.

They are comfortable if sunny, but this depends on the time of day.

Where a wood burning stove has been installed, conservatories are only heated on special occasions, but then heated all day.

Overheating on 3 to 4 days a year. Glare is often more of a problem as ventilation can normally control temperature. Blinds can control glare. No condensation detected.

Conservatories are considered the biggest asset of homes apart from their zero heating requirements and comfortable "feel"

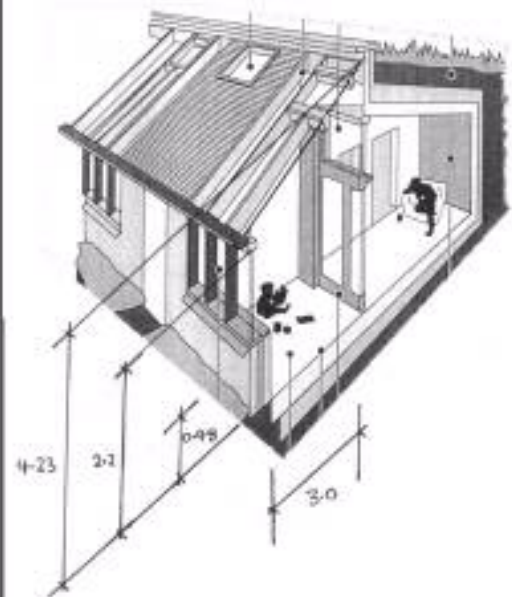

Temperature Distribution Curves for Average Hourly Temperature for Sample Summer Week (12th to 18th July 00) at House 4 Hockerton. (Av. Daily max temp 19.9 deg C)

Temperature Distribution Curves for Average Hourly Temperature in Sample Winter Week (6/4/00 to 12/4/00) at House 4 Hockerton.

