

Sovereign Housing Portsmouth

Paulsgrove Quarry Portsmouth Hampshire UK Latitude : 50.48N

Semi detached houses with full width attached conservatories, semi detached to next house with a brick wall. Side and main wall glazed above a dwarf cavity wall.



- **Glazed sunspaces**
Full width south facing conservatories. Floor area 10 square meters.
- **Sunspaces oriented South**
Double glazing between outside and conservatory.
Double glazing with low E coating between conservatory and house.
- **Frame Type**
Timber between outside and conservatory and between conservatory and house.
- **Height of Glazing**
Full height above a 450 mm high wall between sunspace and outside.
Double doors with between conservatory and house.
- **Description of shading**
Typical suburban shading.
None, but one of the 8 houses monitored uses a garden umbrella in the conservatory .
- **Ventilation**
By opening windows or double doors in conservatory. No low level openings nor roof openings

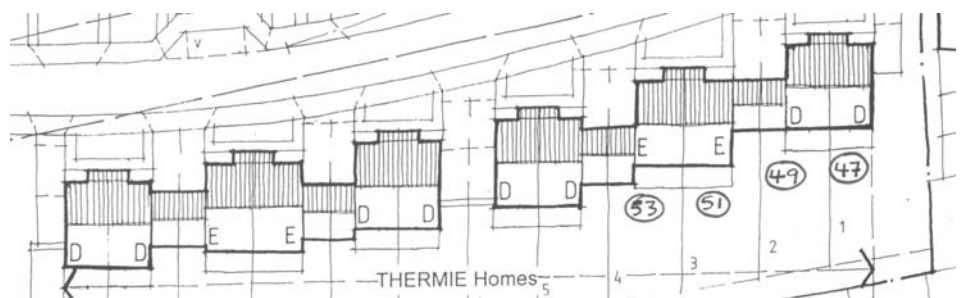
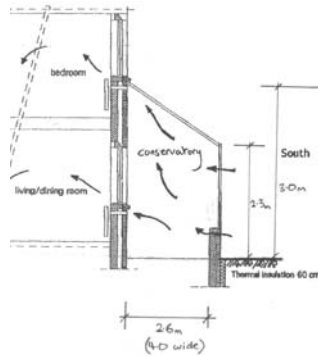

- Mechanical services in sunspace

None

Ventilation is natural

- Floor type

Concrete

- Floor covering

Various coverings, carpet, rugs, vinyl or no covering.

- Monitoring

Conservatories used for occasional sitting and eating, if comfortable. Winter usage typically for storage and clothes drying.

Comfortable if sunny, depends on time of day. Most people find it much too hot in summer.

Some occupants use doors between house and conservatory appropriately for energy saving.

Occupants enjoy the extra space and sitting in the conservatory when it is comfortably warm.

In this example occupants are all on very low incomes and the conservatories are not heated and perceived as an energy saving addition. Previous UK research has indicated that similar conservatories in higher income sectors have been heated, thus increasing energy consumption.



Comparative summer temperatures measured in two conservatories.

